

GROUND PLAN

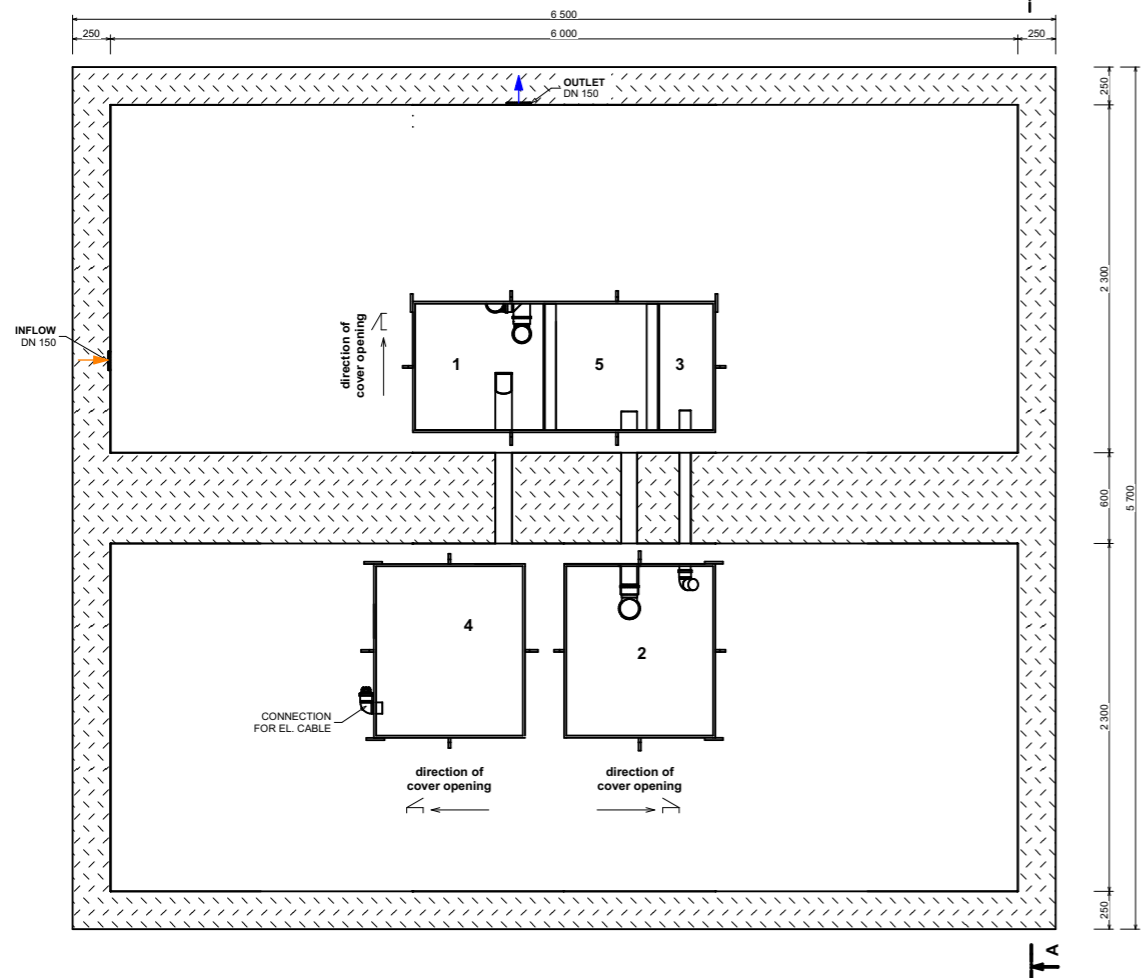

SCHEME OF CONNECTION

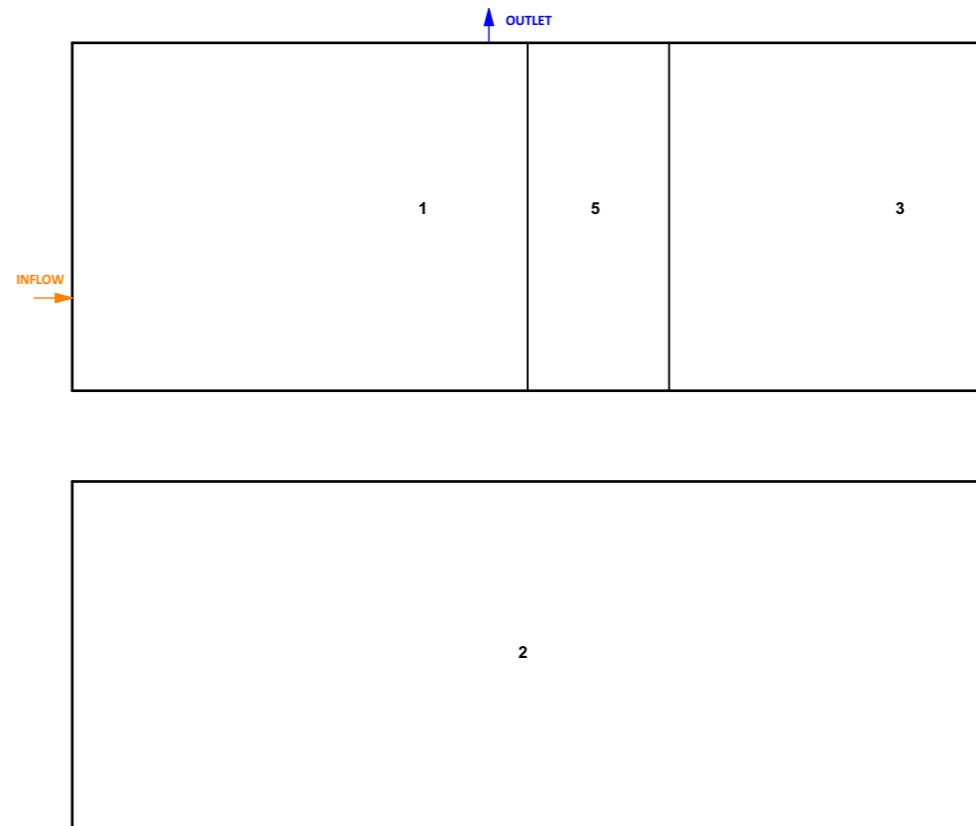

LEGEND:

- 1 INFLOW TANK
  - 2 REACTOR
  - 3 SLUDGE TANK
  - 4 VALVES, CONTROL UNIT
  - 5 SAND FILTER
- 
- A** SURROUNDING GROUND
  - B** EXCAVATED SOIL WITHOUT STONES
  - C** COMPACTED GRAVEL-SAND 100% PGS
  - D** GRAVEL-SAND COEFF. OF FRICTION <math>\leq 0.3</math> BACKFILL IN LAYERS app. ca 0,3 m AND COMPACT TO 100% PGS
  - E** GRAVEL
  - F** CONCRETE SLAB C15/20 REINFORCED WITH KARI NET
  - G** CONCRETE C15/20

INSTALLATION ABOVE THE GROUND WATER LEVEL

SECTION A-A

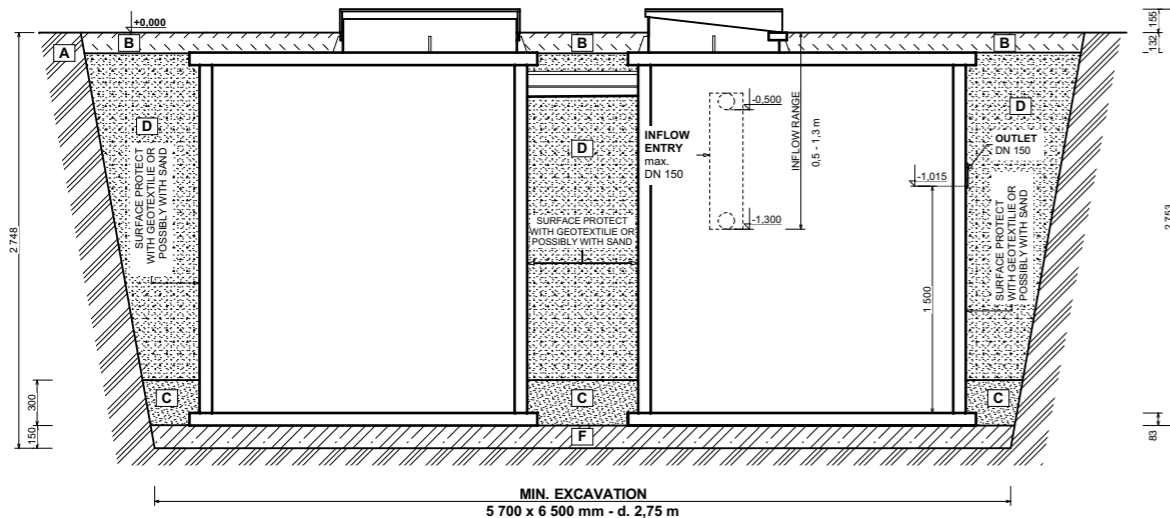

INSTALLATION BELOW THE GROUND WATER LEVEL

SECTION A-A

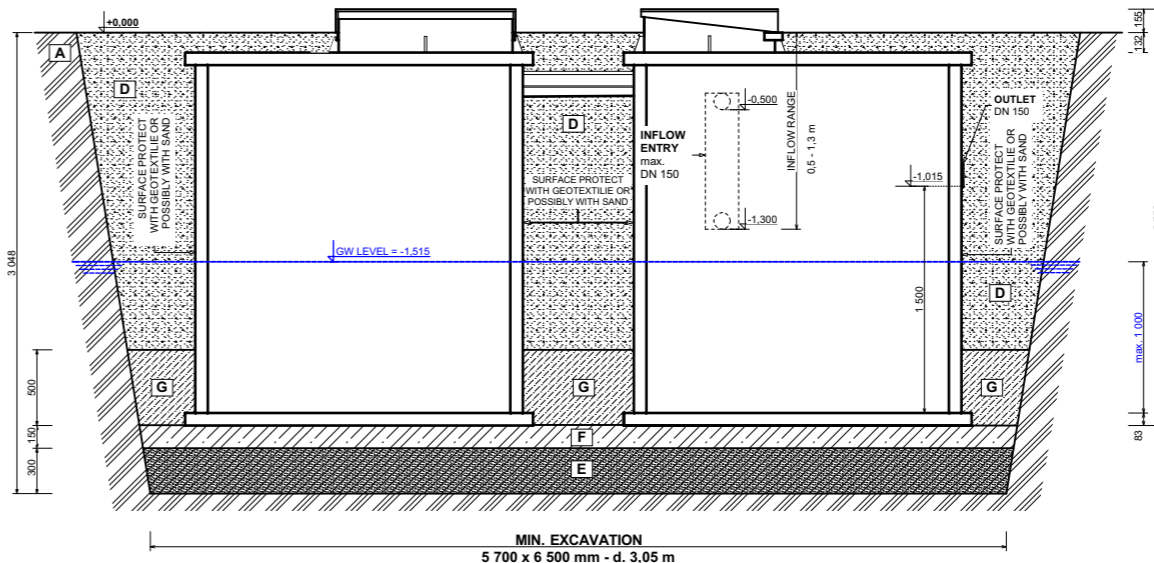

PROJECTION		KRČMÁROVÁ	WEIGHT	5 000 kg	SCALE	1:50
		VILÍM	MATERIAL	PP 2x8 mm	TECHNICAL SHEET	
			Max. flow	24,0 m <sup>3</sup> /day		
			BOD <sub>5</sub>	9,6 kg/day		

 <b>TopolWater, s.r.o.</b> Nad Rezkovcem 1114 286 01 Čáslav	NAME	Biological wastewater treatment plant	NUMBER	IS
	TYPE WWTP		REVISION	
		TOPAS S 160 PF	PAGE	1/1